

Desealer Module (DSM)

Technical Data Sheet

The Desealer module automates removal of aluminum seals from sample tubes. The Desealer module can process simultaneously different tube types and sizes. The aluminum seal (foil) is removed and discarded into the Desealer waste container.

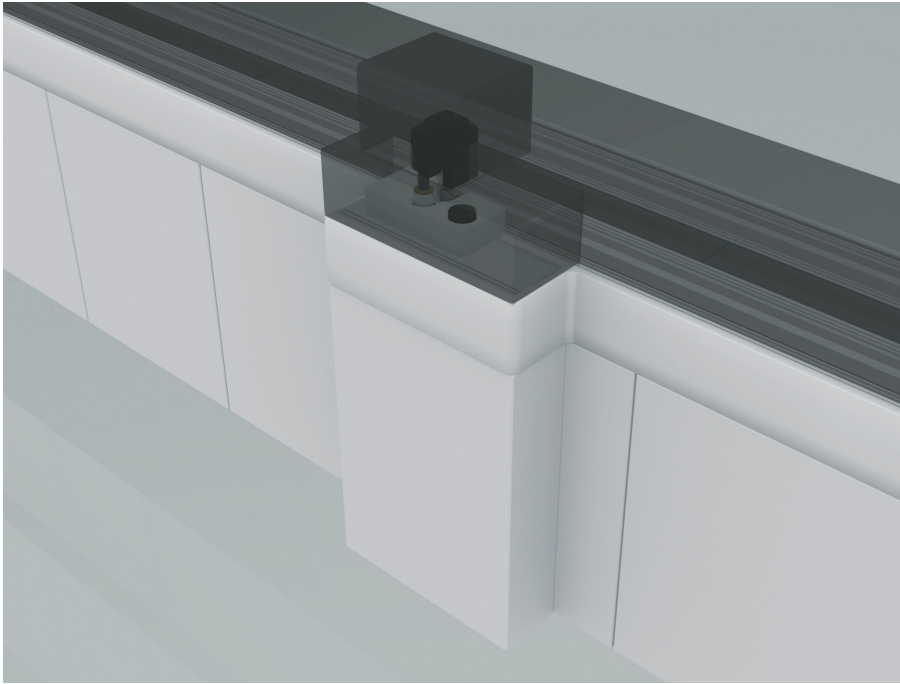

Benefits

- > Improvement of operator safety by avoiding manual unsealing of the sample
- > Reduction of dangerous and dirty tasks from Operator's activities

Applications

- > Unsealing of sample tubes before re-analysis

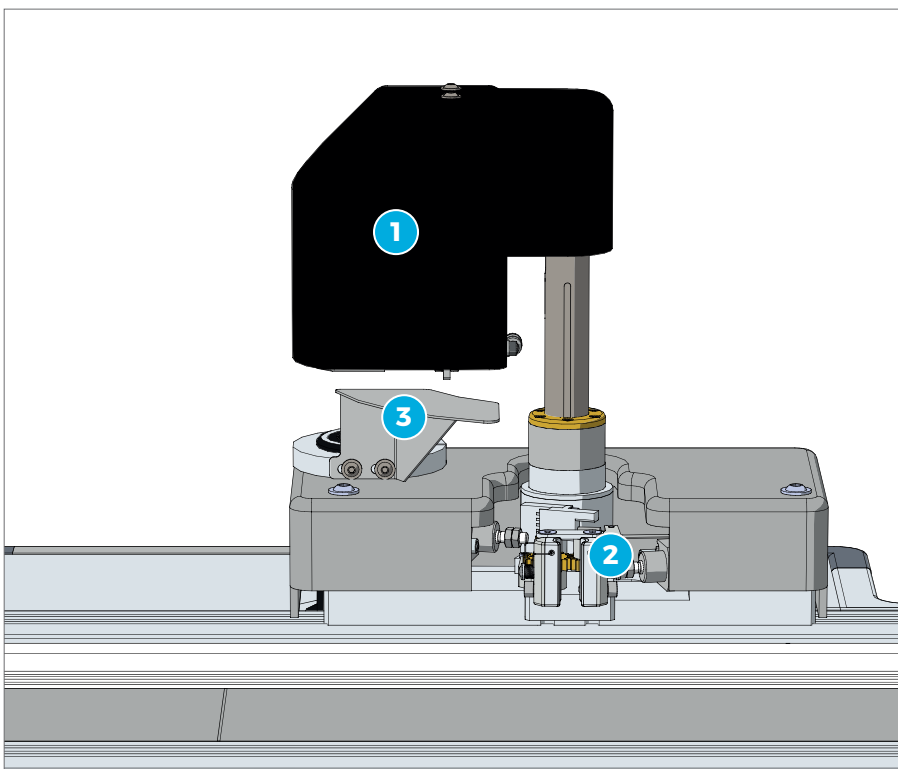

- 1 Desealer Head
- 2 Gripper Pads
- 3 Drip Tray



Main Features

Throughput	Up to 200 tubes/hour
Walk-away capacity	10000 foils (waste container capacity)
Tube specifications	
Sample type	All (spun and unspun)
Cap type	Sealed
Dimensions (mm)	13x75, 13x100, 16x75, 16x100
Position along the automation	Depending by the presence of the Storage, but always before analytical area

The maximum throughput calculations are obtained in optimized and standardized conditions, as tested by Inpeco.

Other Features

- > The aluminum seal (foil) is removed from sample tube and Desealer Head discards it into the DSM waste container
- > DSM has a removable waste container to collect removed aluminum foils

Technical Specifications

Dimensions (LxHxD) (mm)	455x1240x135
Main clearances (left x right x front) (mm)	0x0x425
Weight (Kg)	30
Compressed air (NL/min)	4.17 (Standard) 3.80 (HT)
Power inlet point	24 Vdc

Technical Drawing

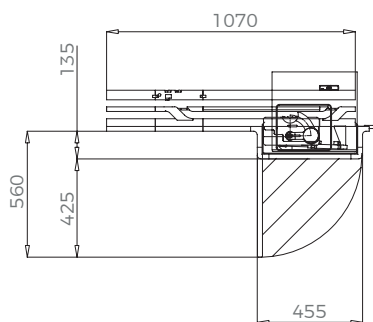

Module dimensions and clearances expressed in mm.

Maximum continuous current (A)	1
Maximum alternate current (A)	/
Real power consumption (W)	34.8
Heat (BTU/h)	65.3

Ordinary Maintenance

Operator ¹	/
Service ²	Every 90-180 days, according to operations

¹ According to Operation Manual. ²The periodicity depends also on the routine tubes/day. For more details refer to Service Manual.

Part Numbers	FlexLab™	FlexLab™ for High Throughput
Configuration	FLX-211-01	FLX-211-11
Slot	FLX-511-01	FLX-511-11